

BETHEL BEACON

Bethel Lutheran Nursing & Rehabilitation Center
701-572-6766

activities@blnrc.com
Bethel Lutheran Foundation - 701-572-0223

foundation@blnrc.com
1515 2nd Avenue West • Williston, North Dakota 58801
Recognizing each individual as a child of God

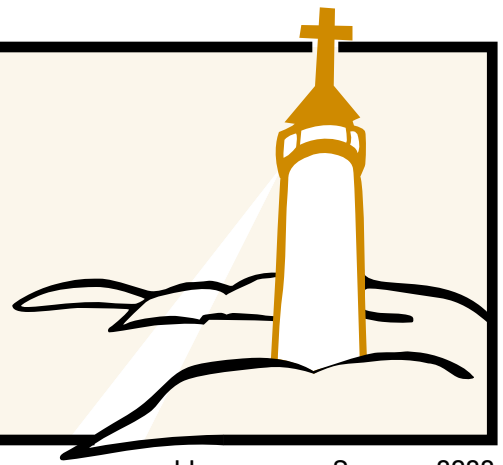

www.blnrc.com Summer 2022

City of Williston, Bethel Lutheran Nursing and Rehabilitation Center ANNOUNCE PLANS FOR NEW FACILITY AT WILLISTON SQUARE

The City of Williston and Bethel Lutheran Nursing and Rehabilitation Center are pleased to announce an agreement for Bethel to purchase an 18.88-acre parcel located within the Williston Square Subdivision. Plans for a new skilled and basic care facility at Williston Square are in the design phase and groundbreaking will be announced later.

"We are very excited to move forward with the building of a new facility. Bethel is committed to providing high-quality care in Williston," said Aaron Schmit, President of the Bethel Board of Directors. "A new modern and homelike facility will allow Bethel to better serve our residents and their families, our employees, and our region, for future generations. We would like to thank the greater Williston community, our employees, our member churches, and the residents and their families we have served for 70 years of support." "Williston is where it is today because of the contributions made by the generations before us. We owe our seniors for all they have done for this community," said Williston Mayor Howard Klug. "The new Bethel facility at Williston Square will provide enhanced care for our seniors close to their friends and families. The city is honored to partner with Bethel on this project at Williston Square."

"We are beyond excited to announce that Bethel Lutheran Nursing & Rehabilitation Center recently completed the purchase of a section of land in the Williston Square Subdivision for the development of a new facility" said Belinda Moen, Administrator, BLNRC. "We recently celebrated 74 years of operation, and through these 74 years

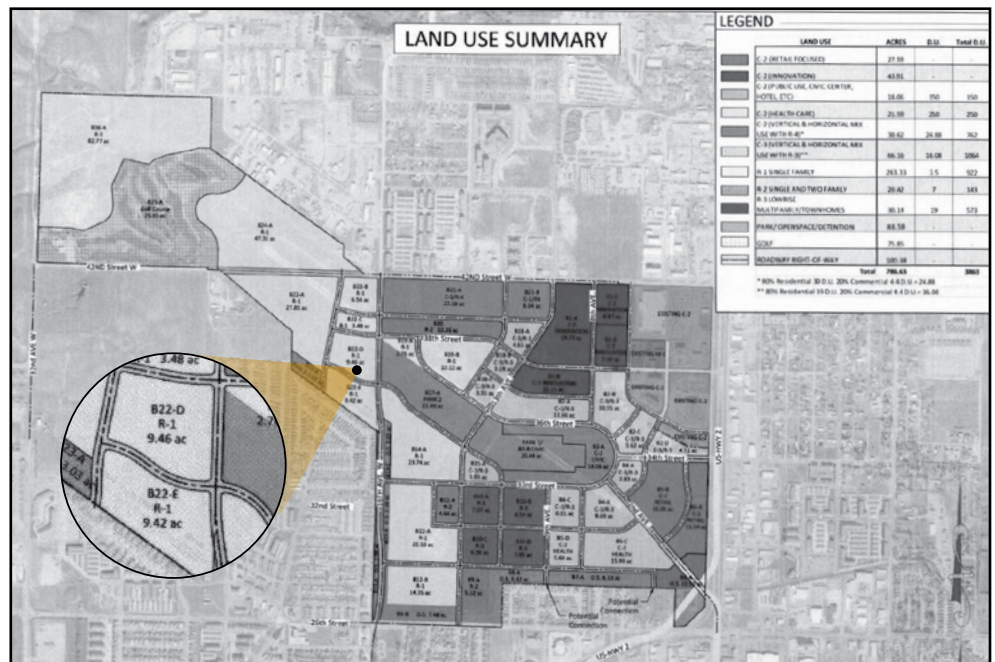

"We are very excited to move forward with the building of a new facility. Bethel is committed to providing high-quality care in Williston"

we have seen many changes to the long-term care industry, and a new building that allows us to meet the needs of our residents, staff, and the community and surrounding areas will ensure our legacy and mission carries on for generations to come. We have reached this point in our journey through hard work and dedication from the Board of Directors, Bethel's senior leadership team and management, and through the generous contributions and donations from the community. We cannot wait to see what the future holds!"



Kurt Stoner – Director

Foundation *Corner*

Although much work still needs to be accomplished before construction can begin, securing the future building site is a really good start. Bethel has explored various prospective sites over the course of the last several years and feels this site best fits its future needs. Bethel's Building Committee will be meeting soon with EAPC Architects to begin the planning and design phase as well as securing updated cost estimates for the project.

Of concern for all involved are the current supply chain issues and its affect on construction costs and the current inflationary price increases. We can only control what we can and we will move forward with a prudent plan. A project this size will have to rely on community and donor support as well as a bond issue to finance the remaining building costs. This will be undoubtedly the largest financial undertaking in Bethel's 74-year history.

There have been many upgrades and additions built on our existing campus; however, the facility is aging past the point of face-lifting and a new facility is needed to continue our long history of providing quality compassionate care to Williston's future generations. The delivery of care has changed immensely and so have the expectations of our residents and their families. Your gifts to Bethel's Building Fund will allow Bethel to continue this legacy. BLNRC and Bethel Foundation will hold its Annual Meeting on September 28, 2022. Please watch for further information concerning its location or if it will once again be held remotely.



We Want You to Join Our Family!

NOW HIRING

Full-time and Part-time Positions Available.

Stop by or visit our website for more information:

www.blncr.com

Staff and Board Members

Bethel Lutheran Nursing & Rehabilitation Center

1515 2nd Ave. West, Williston, ND 58801
701-572-6766

Administrator – Belinda Moen, RN, BSN, MBA, LNHA

Director of Finance – Tiffany Sickinger, CFO

Director of Nursing – Tanya Geise, RN

Chaplain – Pastor Sheldon Sorenson

Human Resources – Gretta Ensrud, SPHR

Social Services Supervisor –

Sarah Tappenden, BSW

Laundry/Housekeeping Supervisor –

Joan Tofte

Clinical Dietician –

Laura Hall, RD, LD

Director of Food Services –

Valerie Barrett

Activities Supervisor – Salina Henke, ADC

Director of Maintenance – Lee Brenna

Board of Directors

Aaron Schmit,

Chairperson

Grant Carns,

Vice Chairperson

Margaret Sundet,

Secretary/

Treasurer

Patti Stewart

Ruth Carlson

Alvina Skogen

Tina Hanson

Kelsey Geltel

Rick Braaten

Arbor House Assisted Living Center

1705 3rd Ave. West, Williston, ND 58801
701-572-2688

Nurse Manager –

Renee Bendixson, LPN

Bethel Lutheran Foundation

1705 3rd Ave. West, Suite 101
Williston, ND 58801, 701-572-0223

Director – Kurt Stoner

Assistant Director – Kathy Harger

Board of Directors

Stuart Lanager,

President

Grant Carns,

Vice President

Margaret Sundet,

Secretary/

Treasurer

Paula Jarland

Ken Kjos



Salina Henke

Activity *Update*

We are looking forward to getting to know the new families that have joined us and getting back to some normalcy here at Bethel Lutheran Nursing & Rehabilitation Center.

Monthly EVENTS

AUGUST

18th Friends and Family BBQ
— 5:30pm

SEPTEMBER

15th Friends and Family BBQ
— 5:30pm

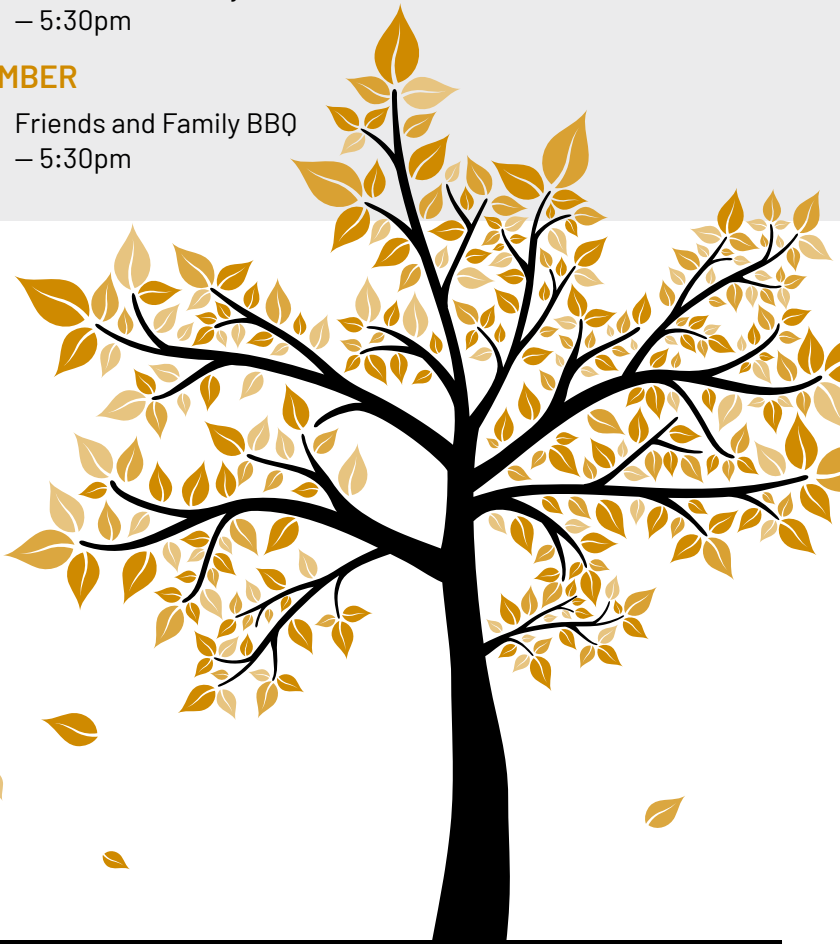

MARK YOUR CALENDARS

Bethel's Annual Meeting
will be held September 28, 2022

BETHEL ACTIVITIES *Daily* EVENTS

MONDAY

Group Exercise – 9:30am
Baking with Jasmine – 10:00am
Coffee Hour – 2:00pm
Bingo – 7:00pm

TUESDAY

Group Exercise – 9:30am
Coffee Hour – 2:00pm
654 Game – 7:00pm

WEDNESDAY

Group Exercise – 9:30am
Gospel Sing A Long – 10:30am
Coffee Hour – 2:00pm
Bingo – 7:00pm

THURSDAY

Group Exercise – 9:30am
Bible Study – 10:00am
Coffee Hour – 2:00pm
Games – 7:00pm

FRIDAY

Group Exercise – 9:30am
Cooking with Salina – 10:00am
Coffee Hour – 2:00pm
Movie and Popcorn – 7:00pm

SATURDAY

Manicures – 1:00pm
Coffee Hour – 2:00pm
Card Games – 3:00pm
Bingo – 7:00pm

SUNDAY

Worship Service, Chapel – 9:30am
Service Social – 10:00am
Coffee Hour – 2:00pm
Grocery Game – 3:00pm

***Monthly and daily calendar events are subject to change. All activities are in the activity room unless stated otherwise.**



Belinda Moen
Administrator

Expanding to Fit Your Needs

BETHEL CONTINUES TO GROW TOWARDS A BRIGHT FUTURE

Hello everyone! I hope this article finds you well and enjoying the beautiful summer weather! Such exciting times at Bethel. We are continuing to make great strides in staffing; within the last two months we have hired 24 of our own certified nurse assistants and three LPN/RN's! The department managers and Human Resources are continuing to work hard to add to the department teams! In addition, I am so excited to be in the finalizing stages of the nurse scholarship program where we will be able to support the career advancement of our nursing staff! This will be in collaboration with Williston State College.

The Board of Directors completed a board retreat with Eide Bailey in June, along with the senior leadership team of Bethel and the Foundation. During this meeting, we discussed strategic planning and goal-setting for the future. It was an amazing meeting and we all left with a renewed feeling of positivity for the future.

I was officially appointed the Administrator on June 28, 2022. I am incredibly honored to have been appointed to this role, and I want to thank the Board of Directors and the staff of Bethel for trusting me in this role.

Lastly, I am beyond excited to announce that we have purchased 18.88 acres of land in the Williston Square subdivision for the building and construction of our new facility. This has been a long process, not without bumps along the way, and it would not be possible without the hard work and dedication from the Board of Directors, the Foundation, the Bethel Building Committee, and Senior Management, Management and Staff of Bethel. To be able to offer the community and surrounding areas with a state-of-the-art facility that will better meet their needs is an incredible....just incredible honor. Thank you to all who remained committed to this goal and continue to do so! God Bless!

50 Years of Dedication

Verna Nicks, who is turning 91 in just a couple of weeks, has dedicated her life to helping the residents at Bethel Lutheran Home in Williston. Starting in August of 1975, Nicks spends at least three to four days working in the laundry department, acting as the only on-staff seamstress, and documenting new residents' items. "I just heard there was a position open in laundry and decided to go back to work. My kids were all off and graduated..." Nicks said about finding the job opening almost 47 years ago. After being hired on, Nicks spent 25 years as a laundry washer and then retired. It wasn't long before Nicks' supervisor called her and asked if she would be willing to come back to work.

"I think she might be here longer than I will be" said Joan Tofte, Nicks' supervisor. Tofte was hired at Bethel about 25 years ago and explained that Nicks really helped her acclimate to the position. Describing Nicks as an exemplary worker who always shows up for work and willing to pick up extra shifts when needed, Tofte said Nicks is a "blessing to Bethel."

Every shift, Nicks' daughter or grandkids pick her up from home to get to work, because Nicks doesn't drive. Using a walker and other mobility aids to get around, Nicks never lets that slow her down. "She can keep up with everybody!" said Tofte. Tofte explained that not only does Nicks show up, but

when she is on-duty, there is a high bar to be met. "She's the only one who likes to iron, and if another staff member wants to just hang the clothes up and send them that way, Verna will stop them and say, 'We don't send that up like that!'" said Tofte.

Nicks' favorite part of the job is the relationship-building she gets to do with residents and other staff members. Nicks explained that the people at Bethel really became family to her. She even makes sure everyone feels special on their birthday, making sure there is always a cake to celebrate. "It's made life more interesting, and I always have friends." said Nicks.

Outside of work, Nicks enjoys spending time with her grandkids and great-grandchild. She also enjoys knitting, sewing, coloring, and completing word finds. "I don't have to work; I just love to work. Maybe when I'm 100 I'll retire," said Nicks.



Verna Nicks - Long Term Employee Bethel Lutheran Home
Maddie Davis - Williston Herald

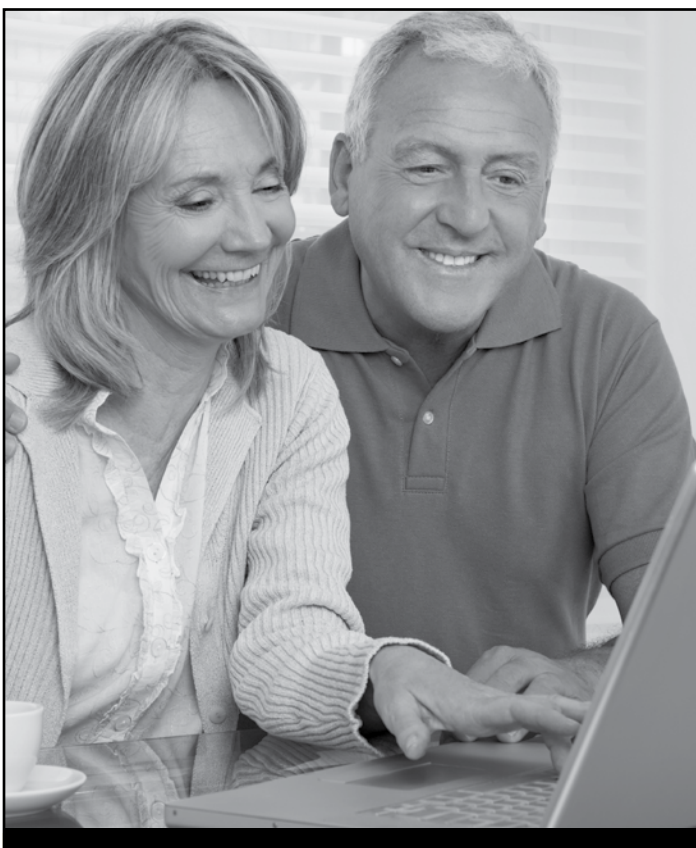

Did you know we offer electronic giving?

You can contribute anywhere, anytime right from your computer, smartphone or tablet. Give online by visiting our website at **blnrc.com** and clicking the "Give Online" tab in the lower left corner. Get started today!



Please consider supporting Bethel with a charitable gift today!

Visit **blnrc.com** to donate!

HAPPY BIRTHDAY *To you!*

Bethel Birthdays

AUGUST

10th Mary Borrud
22nd Donald Amundson

SEPTEMBER

8th Velma Lee
16th LaVonne Pederson

OCTOBER

6th Harold Tofte
12th Georgina Linghor
14th Constance Maas
21st Leona Hanson

NOVEMBER

2nd Joyce Frank

ADMITS

Beverly Lobsinger
Ardell Smith
Hilda Banning
Marilyn Immenschuh

DISCHARGED

Ruby Jacobson

GOD BLESS THE MEMORY OF OUR DECEASED FRIENDS

Kenneth Cole

Arbor House Birthdays

AUGUST

1st Kay Bendixson
11th Audrey Olson
13th Eleanor Olson
24th Kaye Becker

SEPTEMBER

10th Dolores Olson
21st Ethel Thompson

OCTOBER

18th Tim Roen

NOVEMBER

20th Wanda Wehrman

DECEMBER

13th Phyllis Lufkin
15th Ardean Aafedt

LOOKING FOR ARBOR HOUSE VOLUNTEERS

Can you carry a tune, make a craft or tell a story? Are you a member of a 4H club, service group or choir? We want you hear!

Contact Dora at Arbor House by calling 572.2688, if you'd like to volunteer!

Employees OF THE MONTH

APRIL 2022

Geri Quano

MORE ABOUT GERI:

Geri is a middle child who graduated in Nursing from Cebu Doctors University in the Philippines in 2011. He spent almost 7 years working as a staff nurse and charge nurse in Cebu Doctors Hospital before coming to America. He said it was hard but exciting to be in a new country alone. Geri was nervous to start at Bethel, as LTC was new for him, but everyone was so helpful — he didn't realize working in a nursing home could be fun! Geri loves playing video games and building model kits. He also loves nature (summer at least!) and enjoys going to national parks. His strengths are his ability to work with anyone and staying focused on a task until it is done.

NOMINATION COMMENTS:

The electrical fire could have been so much worse if it wasn't for his quick response. He shut off power, extinguished the fire and evacuated the residents. He took control of the situation - a true hero and deserving of this honor!

MAY 2022

Makeba "Kiki" Scott



MORE ABOUT KIKI:

Kiki was born and raised in Detroit, MI, and is the mother of 4, 3 boys and 1 girl. She likes to shop, go out to eat and play darts. She worked for a daycare in Michigan for 12 years and has been part of the Bethel team going on five months. When asked what the best thing about Bethel is, she said "I love working to help the elderly in any way I can. I absolutely love everything about my job."

NOMINATION COMMENTS:

Kiki is very patient, caring, polite, considerate and doesn't rush us. She goes above and beyond for anything that we need. She accommodates any situation and is very deserving of being nominated!

JUNE 2022

Edith Jennings



MORE ABOUT EDITH:

Edith was born and raised in Mills River, NC, and is the only girl with 3 older brothers. She graduated from West Henderson High. She likes to hike, listen to music and to write. She has been at Bethel for 3 months and works on our housekeeping team. Edith says the thing she likes about her job is that everyone is so welcoming and nice. She says Bethel feels like a family and the best part is the residents!

NOMINATION COMMENTS:

Edith goes above and beyond in her attention to detail and friendly manner while at work. She does her job well with enthusiasm and always carries a smile. She gets along with all her teammates, is not afraid to help when needed. Her compassion to her residents is greatly noted by her stopping and helping them or just listening to them with a caring ear.

JULY 2022

Leo Muniz



MORE ABOUT LEO:

Leo was born in Rocky Ford, CO, and raised in Ft. Collins, CO. He has a high school education and is married with a daughter, son-in-law and 2 grandchildren. He is blessed to have his daughter and her family here in Williston. His interests are wood working, reading non-fiction, light mechanic work on autos and watching Netflix. He has worked at Bethel for 3 years in Housekeeping and enjoys spending time with his wife. The thing he likes best about Bethel is the friendliness of residents and staff and working to the best of his ability.

NOMINATION COMMENTS:

He is hands down the nicest person at Bethel! He is in his 80's and is very dependable. He works in all areas and comes in with a smile and a "Hello!" for everyone. He does his job well and genuinely cares about all the residents and co-workers. He truly is one-in-a-million!!

Congrats! **THANK YOU FOR ALL THAT YOU DO AT BETHEL.**



NUTRITION TIP

by Laura Hall, RD, LD Clinical Dietitian

Greek Salad



INGREDIENTS

Dressing

- ¼ cup extra-virgin olive oil
- 3 tbsps red wine vinegar
- 1 garlic clove, *minced*
- ½ tsp dried oregano, more for sprinkling
- ¼ teaspoon Dijon mustard
- ¼ teaspoon sea salt
- Freshly ground black pepper

For the Salad

- 1 English cucumber, *cut lengthwise, seeded, and sliced ¼-inch thick*
- 1 green bell pepper, chopped into 1-inch pieces
- 2 cups halved cherry tomatoes
- 5 ounces feta cheese, *cut into ½ inch cubes**
- ⅓ cup thinly sliced red onion
- ⅓ cup *pitted Kalamata olives*
- ⅓ cup *fresh mint leaves*

DIRECTIONS

1. Make the dressing: In a small bowl, whisk together the olive oil, vinegar, garlic, oregano, mustard, salt, and several grinds of pepper.

2. On a large platter, arrange the cucumber, green pepper, cherry tomatoes, feta cheese, red onions, and olives. Drizzle with the dressing and very gently toss. Sprinkle with a few generous pinches of oregano and top with the mint leaves. Season to taste and serve.

Your Support IS NEEDED

Bethel depends on our church sponsors and community. We are very appreciative of your financial gifts that improve the lives of the residents we serve. Resident rates are set/limited by North Dakota's rate equalization reimbursement system. North Dakota Medicaid and Medicare rates typically (hopefully) cover the cost of providing direct care to our residents. However, our Foundation is looked upon to help support facility improvements and other quality of life services. Please consider one of the following ways you could make a positive difference in the quality of care Bethel provides.

GIFTS OF CASH: The easiest way to obtain a charitable deduction is to support Bethel through a cash gift. If you itemize, your gift may be fully deductible.

BEQUEST/WILL: Consider naming Bethel in your will for any fixed or proportionate share of your estate.

GIFTS OF APPRECIATED STOCKS/BONDS: Giving long-term appreciated stocks or bonds avoids capital gains tax and you will receive an immediate tax deduction based on the full fair market value on the date of the transfer.

GIFTS OF LIFE INSURANCE: Designating Bethel Lutheran Foundation as the owner and beneficiary of an existing or new insurance policy usually offers a tax advantage in the year the gift was made. If the policy is paid up, the charitable deduction will be the cash value at the time of the gift. If the policy is not paid up, you continue to pay annual premiums which will become tax deductible to you each year.

GIFTS OF REAL ESTATE: If you have owned rental property, farmland or other real estate for many years, a charitable gift of that property can be especially tax advantageous. If sold outright, the sale could result in capital gains on any appreciation, and ordinary income on any depreciation recaptured. A charitable gift to Bethel may avoid the tax consequence and realize a charitable deduction for the full market value of the real estate.

There are many ways to support the Mission of Bethel, please consult your tax advisor or call the Bethel Foundation office at 701.572.0223.



Chaplain's *Corner*

– with Pastor Sheldon Sorenson

Summer is a time to celebrate growing things. Some people have a gift for growing things. And some people have a gift for throwing things out that have died.

How does a garden grow? You start with good soil and add fertilizer. You need good seed and then you add water. What a difference it makes when we receive rain. Of course, there are always weeds that need to be pulled. That is a good job for children and grandchildren if you can teach them the difference between the weeds and the growing plants.

What really makes a garden grow is sunlight. Plants have the ability to take energy from the sun and convert it to chemical energy that helps make the things growing taste good; except for some vegetables that I find hard to eat no matter how they are prepared. Yet, without the light of the sun, nothing else matters.

God intends for us to bear fruit – Fruit that will last, the more His light shines upon us, the more His light can shine through us. At times it may seem that no growth is taking place. But, if we continue to abide in Him, in due time, there will be a bountiful harvest.

Fruit is not manufactured; it comes when certain conditions are met. If we abide in Him, don't worry if nothing seems to be happening in our lives, If there is eternal life, there will be eternal rewards. Don't give up because you don't see the fruit. Instead, go be the fruit bearer He created you to be.



"He will be like a tree firmly planted by streams of water, which yields its fruit in season. And its leaf does not wither; and in whatever he does, he prospers."

– Psalm 1:3

Bethel's Activities



Baking



2022 Prom



Marching Band

& Margaritas!



Golden Estates Easter Egg Hunt



Arbor House Activities



You Will Be Missed!

HAPPY RETIREMENT

I started working at Bethel as a charge nurse in 1988. When I first started, I said, "This will do until I find something else!" I guess I never found any place else I wanted to work, until 2010, when Arbor House opened and I became the Manager. But, still employed by Bethel. I have seen many changes through the years, made many friends, young and old. I have learned so much about life from the elders I have had the opportunity to take care of. The elders have so many great stories! I will miss the stories and their smiling faces. When I became a nurse in 1973, I had no idea how rewarding my career of taking care of the elderly would be. All this has been fulfilled while working for Bethel. I want to Thank everyone for the good wishes and kind words as I retire. Now it is time for the next chapter in my life. I will see you around. — Faye

EXPRESSING *Our Gratitude*

Bethel Lutheran Foundation is a non-profit organization, dependent on gifts and endowments from individuals, foundations and corporations. In addition to cash gifts, planned giving donations are made through gift annuities, charitable remainder trusts, insurance policies, stocks, real estate, and bequests from wills.

The Foundation is very grateful to all donors. Your contribution ensures that Bethel Home and its services continue to be the very best—now and in the future.

Contributions may be made payable to: Bethel Lutheran Foundation

Mailing address: 1705 3rd Ave. W. #101, Williston, North Dakota 58801

Contributions listed below were received between April 2022 – July 2022.

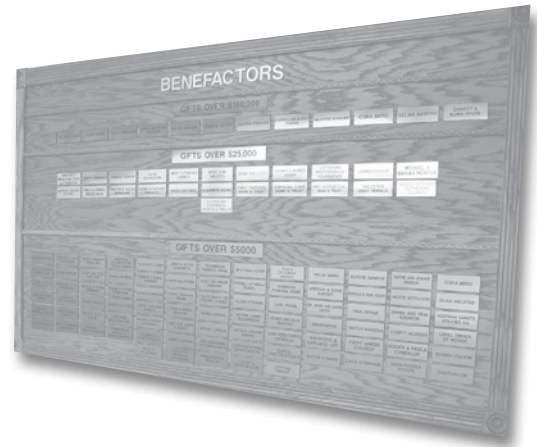

ANNUAL FUND

Lorilee Bott
First Lutheran Church
Harry & Hannah Henderson
Gloria Dei Lutheran Church
Our Redeemers
Lutheran Church
Our Saviors Lutheran
Ray WELCA
St. Olaf Lutheran Church
Women of Grace

BETHEL BUILDING FUND

Lorilee Bott

IN HONOR OF

Bethel's Staff and Residents (Past & Present)

Lorilee Bott

Bethel Staff

Glenn & Susan Jorgenson

Robert Halseth

Glenn & Susan Jorgenson

Cheryl Lingenfelter

Lowell & Carol J. Sandvik

Melva Sogard's 103rd Birthday

David Sogard

In honor of all the men and women who worked so hard to get electricity on in town and rural areas

Floyd & Lyla Semenko

IN MEMORY OF

Allen Allard

Ron & Betty Jo Falcon

Lois Papineau

Floyd & Lyla Semenko

Evonne Anderson

Dale Livdahl

Bernie Arcand

Joyce Viall

Jerome Bakke

Marilyn Bakke

Lylas Bowman

Sanford & Carol Qvale

Floyd & Lyla Semenko

R.A. Tugaw

Gordon Brokaw

David & VeAnna Selid

Terry Carns

Ron & Betty Jo Falcon

Gert Christianson

Judy & Armand Barbot

Dave & Carol Hauser

David & VeAnna Selid

Kurt & Lynette Stoner

Bill Cole

David & VeAnna Selid

Pat Conlin

James McKenzie

Ken Erickson

Dale Livdahl

Wayne & Cindy Sorenson

Donna Sundby Folven

Folven Family

Mary Ann Gaudreau

Jack & Merle Heller

Lorna Hodgkin

Harriet Storoe

Delores Grimson

Tammie Hill

Rosella Hagen

Dennis & Jackie Grubb

Dale Livdahl

Jim Hampton

Dennis & Jackie Grubb

Floyd & Lyla Semenko

Curtis A. Hansen

Vern & Jacki Barman

Ron & Betty Jo Falcon

Linda Stordahl

Noral Haugen

Ardean Aafedt

Larry & Dede Bean

Mary Ann Gaudreau

Kathy Harger

Jack & Merle Heller

Lorna Hodgkin

Kari Lee

Jim & Sharon Moline

Ione Reder

David & VeAnna Selid

Kurt & Lynette Stoner

John Kuester

Sanford & Carol Qvale

Margaret Lee

Mitch & Charmayne Owan

Rev. Tom Lee

Ardean Aafedt

Carroll Lynch

Arlan & Gayle Arnson

Pat & Kim Hennessy

Mildred Haugen

Wilma Hillstead

Marilyn McGinley

Bonnie Stevens

David & VeAnna Selid

Floyd & Lyla Semenko

Kurt & Lynette Stoner

Jason Moor

Ron & Betty Jo Falcon

Martha Njos

Jeraldine Thompson

Dorothy Olson

Sanford & Carol Qvale

Harvey Olson

Jeanne & Duane Buschta

Robert & Faye Coleman

Shirley Olson

David & VeAnna Selid

Sanford & Carol Qvale

Roger Paulson

Tom & Denise Weyrauch

Lois Papineau

Edith Anderson

Gary Bickel

JoAnne Christensen

Greg & Kim DeLorme

Family of Lois Papineau

Geri Hanson

John & Diane Hagen

Paula Hagen

Larry & Dorinne Haug

Joyce Krabseth

Cheryl & A.L. Landro

Jeanne Olson

Charles & Sharon Paschke

Laurie & George Pederson

Kristi Pesek

Cecilia Ranum

Earl & Lois Rennerfeldt

Dave & Deb Richter

Lowell & Carol J. Sandvik

Floyd & Lyla Semenko

Elva Smith

Charlene Strand

Isaac & Jacee Vandyke

Mark & Laurie Wrolson

Ellen Privratsky

Sanford & Carol Qvale

Clarence (Sonny) Raveling

Jeraldine Thompson

Tim Rossland

Jim & Sharon Moline

Sylvia Simle
 Pauline Everson
Jim & Myrna Shannon
 Dennis Hughes & Family
Jerry Stordahl
 Michael & Sarah Devries
 Mary Ann Gaudreau
 OB Gunderson
 Glenn & Susan Jorgenson
 Dick & Marg McKennett

James McKenzie
 Jim & Sharon Moline
 Lowell & Carol J. Sandvik
Norm Streifel
 Floyd & Lyla Semenko
Arlene Tvedt
 Mary Ann Gaudreau
Myrna Tveter
 R.L. & Kim Knick

Coral Whisenand
 Ardean Aafedt
 Fred Whisenand
Rita Wickum
 Larry & Dede Bean
 Jolene Burke
 Maureen & Larry Laqua
 Bill & Tammy LaCrosse
 Charlie & Sam Miller
 Kerry Monson

Darrell & Della Njos
 Bob and Shelly Quackenbush
 Lowell & Carol J. Sandvik
 Peggy Schill
 David & VeAnna Selid
 Jacob and Kristin Stoltz
 Marcella Storseth
 Doran & Cyndee Weigel
 Roger Wickum
 Sanford Wickum

College for Seniors HAS BEEN CANCELLED

It is with sadness and disappointment that we announce the cancellation once again for this year's College for Seniors. Covid cases are on the rise in our region and as much as we all hoped that it would go away, it is still very much impacting the lives of our residents and community.

Beginning in June, we witnessed the progression of the County Transmission levels increase from moderate to substantial and now it was classified as high for the entire month of July. When transmission levels are at the substantial and high levels, large indoor events are not recommended for the safety of those who will be attending.

These transmission levels also dictate when Bethel is required to hold Covid testing events and how often.

For the safety of all we have made the difficult, yet wise, decision to cancel. Bethel and the Foundation have remained steadfast in doing all that we can to protect our residents. We hope to resume the event next year and wish everyone a happy and healthy summer. Thank you for understanding.

Dawn Birkeland, LPN
 Infection Control
 BLNRC

Kurt Stoner
 Foundation Director

Arbor House Assisted Living



IMMEDIATE OPENINGS!

For more information on the services and amenities available for the care level you are seeking, please email or give us a call to set up a tour.

Renee Bendixson
rbendixson@blnrc.com
Ph: 701.572.2688

Please make an appointment for a tour.



1705 3rd Avenue West | Williston, ND 58801
 Ph: 701.572.2688
www.blnrc.com



Bethel Lutheran Foundation

1705 3rd Ave. W #101

Williston, ND 58801

www.blncr.com

ADDRESS SERVICE REQUESTED

Non-Profit Org.
U.S. Postage
PAID
Bismarck, ND
Permit # 433

Golden Estates Independent Living

SENIOR FRIENDLY • QUIET • AFFORDABLE



IMMEDIATE OPENINGS

come in for a tour



Golden Estates • 56 22nd Street West • Williston, ND 58801 • PH 701-774-8089 www.blncr.com

FOR MORE INFORMATION, CONTACT: Kurt Stoner, Bethel Lutheran Foundation
1705 3rd Avenue West #101, Williston, ND 58801 • PHONE 701-572-0223

